

### JEEP JK 2007-18 License Plate Relocation Bracket

Thank you for choosing Rough Country for all your vehicle needs.

Please read instructions before beginning installation. Check the kit hardware against the kit contents shown below. Be sure you have all needed parts and know where they go.

If question exist, please call us @1-800-222-7023. We will be happy to answer any questions concerning this product.

Check all fasteners for proper torque. Check to ensure for adequate clearance between all components.

Check and retighten hardware at 50 miles and again at 500 miles. Periodically check all hardware for tightness.

**KIT CONTENTS:**

- Lug Adapters x 2
- License Relocation Bracket x 1
- License Adjustable Upper Bracket x 1
- License Adjustable Lower Bracket x 1
- Tag Light 72 Inch Lead x 1

**TOOLS NEEDED:**

- 4MM Allen Wrench
- 5MM Allen Wrench
- 10MM Wrench
- 13MM Wrench
- 19MM Socket
- Wire Cutter
- Wire Stripper
- Wire Crimper
- Ratchet

**HARDWARE INCLUDED:**

- M8-1.25 x 25mm Button Head Bolts x 6
- M8-1.25 Nylon Nut x 4
- 1/4-20x1/2 BHCS x 4
- 1/4-20 Nylock Nuts x 4
- 24-22GA. Butt Connector x 2



**Torque Specs:**

Size	Grade 5	Grade 8	Size	Class 8.8	Class 10.9
5/16"	15 ft/lbs	20ft/lbs	6MM	5ft/lbs	9ft/lbs
3/8"	30 ft/lbs	35ft/lbs	8MM	18ft/lbs	23ft/lbs
7/16"	45 ft/lbs	60ft/lbs	10MM	32ft/lbs	45ft/lbs
1/2"	65 ft/lbs	90ft/lbs	12MM	55ft/lbs	75ft/lbs
9/16"	95 ft/lbs	130ft/lbs	14MM	85ft/lbs	120ft/lbs
5/8"	135ft/lbs	175ft/lbs	16MM	130ft/lbs	165ft/lbs
3/4"	185ft/lbs	280ft/lbs	18MM	170ft/lbs	240ft/lbs



1. Remove the top 2 lug nuts from the spare tire, if stock use a 19mm socket.
2. Install the lug nut adapters (70055BAG1), torque to spec using a 19mm socket. **See Photo 1.**
3. Install the lower bracket and cover plate onto the lug adapters, using the supplied (2) M8-1.25 x 25mm bolts (10541BAG2), tighten using a 5MM Allen wrench. **See Photo 2.**

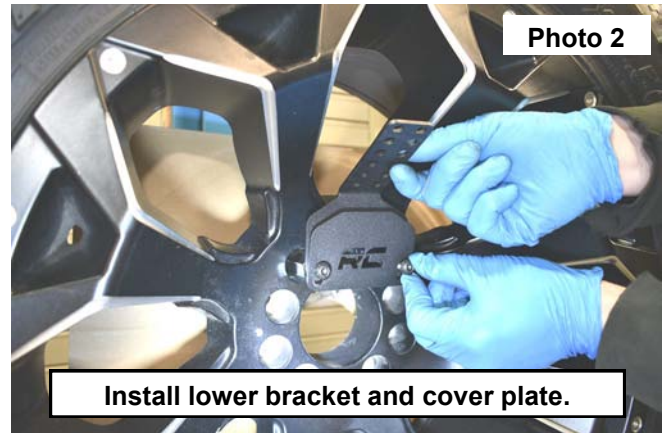
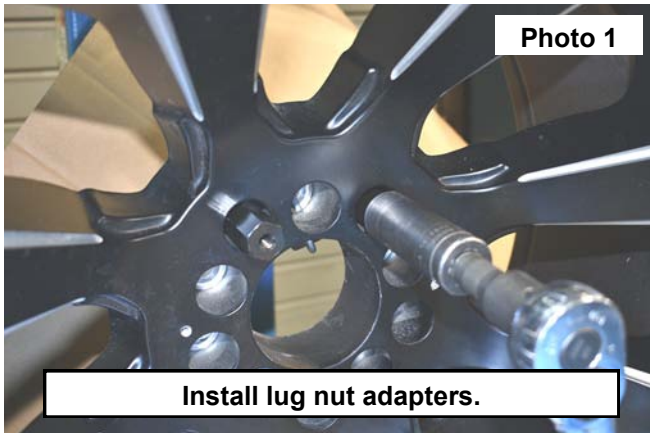

4. Install the middle bracket onto the license plate bracket, use the supplied (2) M8-1.25 x 25mm bolts, (2) M8-1.25 nuts (10534BAG1). **See Photo 3.** Tighten using a 5mm Allen wrench and a 13mm wrench.
5. Install the tag light wire (10534BAG1) into the top hole of the license plate bracket, tighten using an 10mm wrench **See Photo 4.**

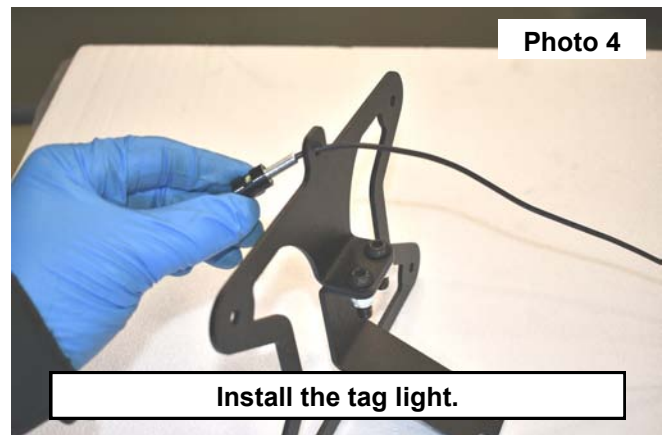
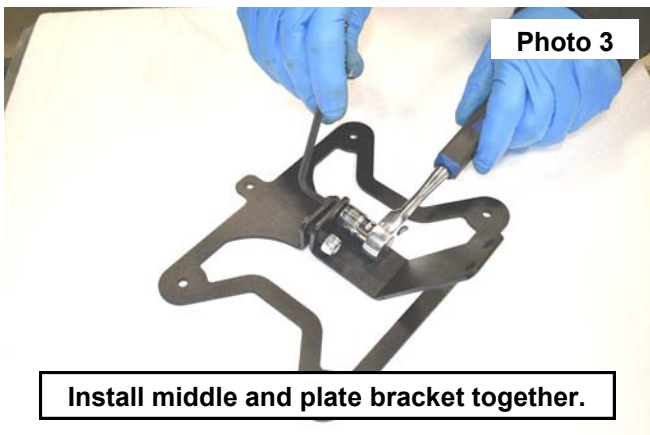

6. Install the assembled pieces onto the lower bracket, **See Photo 5.** Use the supplied (2) M8-1.25 x 25mm bolts, and (2) M8-1.25 nuts (10534BAG1).
7. Choose the 2 holes on the lower bracket that gives the license plate bracket enough clearance in between the wheel and tire. **See Photo 6.**

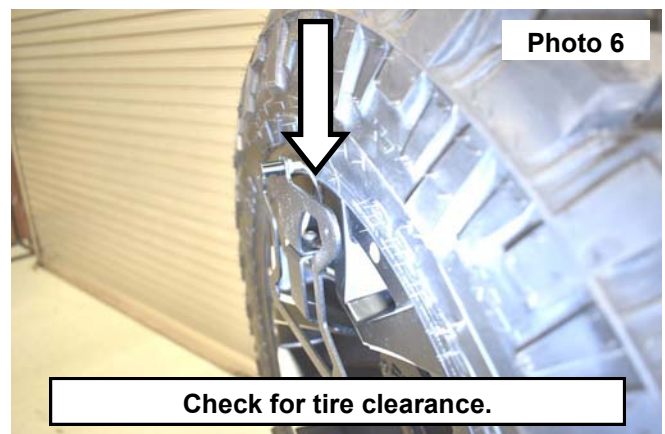
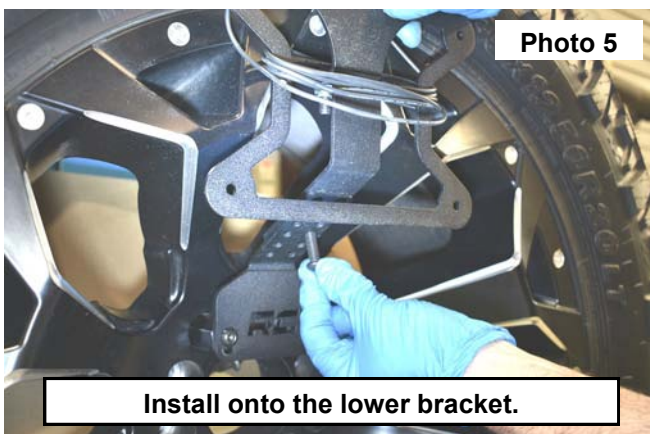



8. Tighten the middle and the lower bracket, using a 5mm Allen and a 13mm wrench. **See Photo 7.**
9. Install the license plate onto the plate bracket, using the supplied (4) 1/4-20 x 1/2 BHCS, and (4) 1/4-20 nuts (10534BAG1), **See Photo 8.** Tighten using a 4mm Allen and a 11mm wrench.

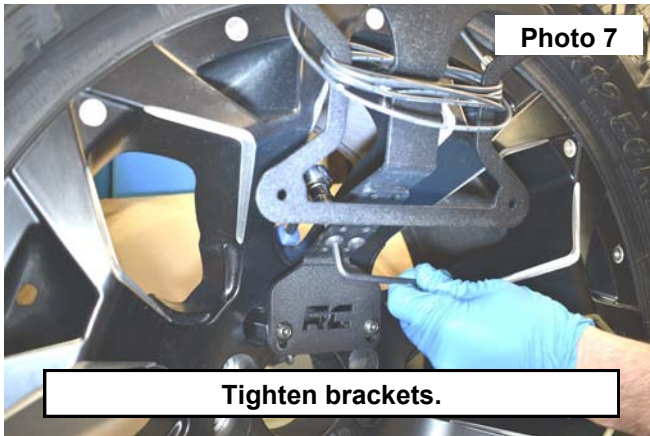

**Wiring the tag light to the parking light wires.**

1. Remove the gromet from the left side of the tailgate, cut a small hole through the plug just big enough to insert the wire. **See Photo 1.**
2. Remove the 2 trim panels from the tailgate, use care to remove the clips, these will be reused. **See Photo 2 and 3.**

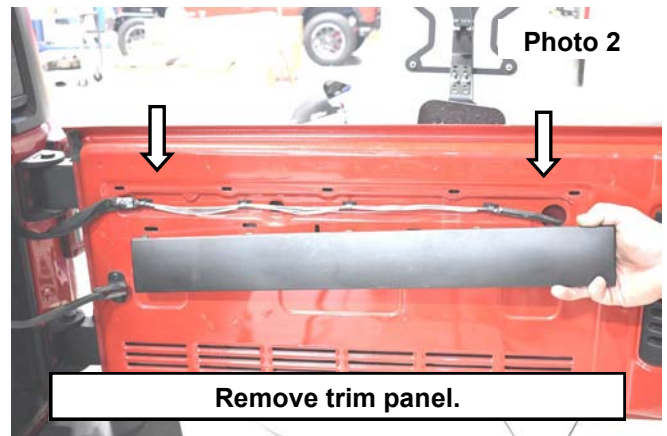
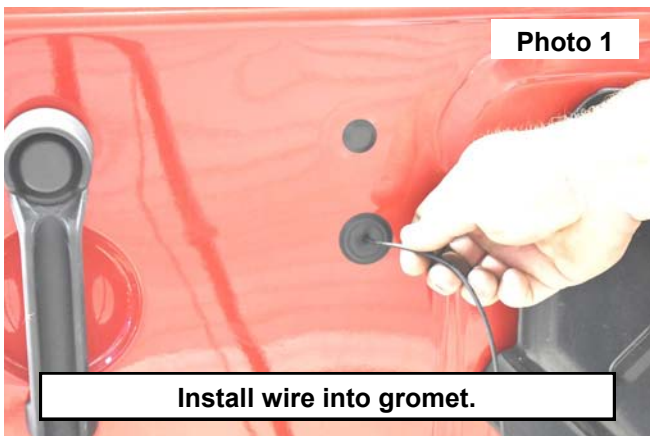

3. Remove tail light by removing the 2 inner screws using a Philips head screw driver then turn the tail light to the outside to remove. **See Photo 4.** Retain hardware and tail light for reuse.

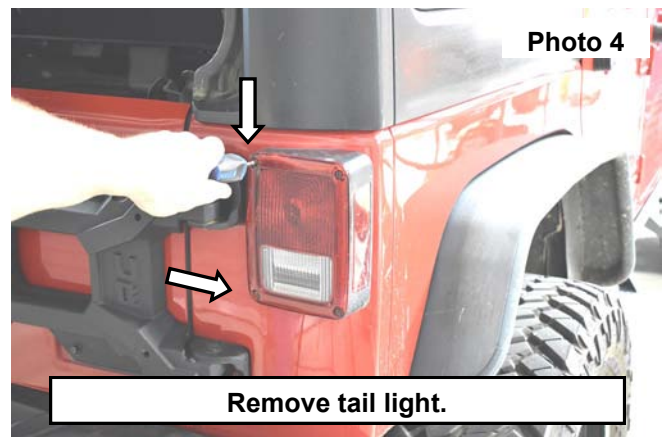
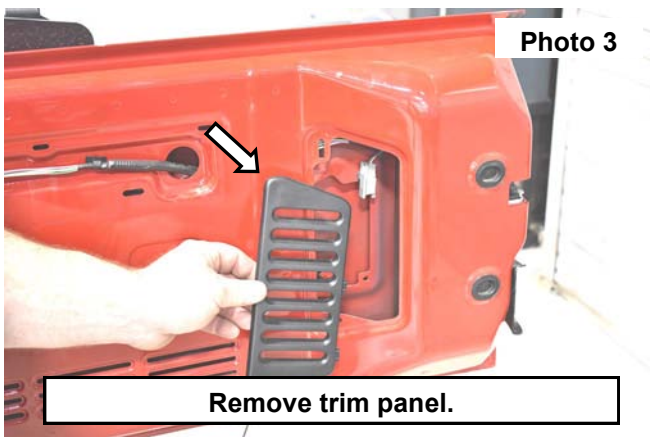

4. **Note the top/clip side of the plug.** Push the tab down to unlock then unplug the wiring harness from the tail light. **See Photo 5.**
5. Jeeps equipped with the rear speaker will need to remove the 2 bolts in the floor, use a T30 torx to remove. **See Photo 6.** Set aside and retain hardware for reuse.

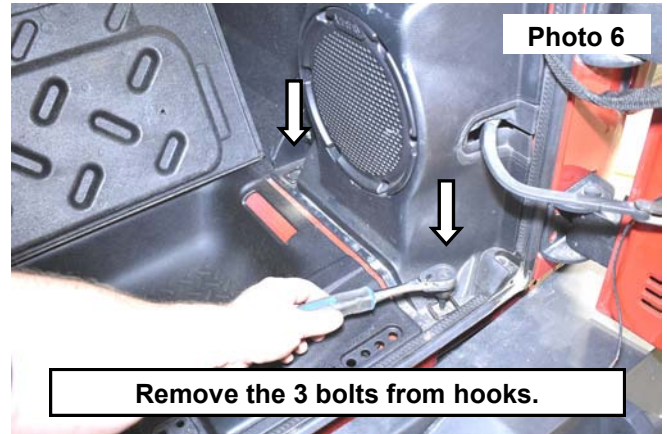
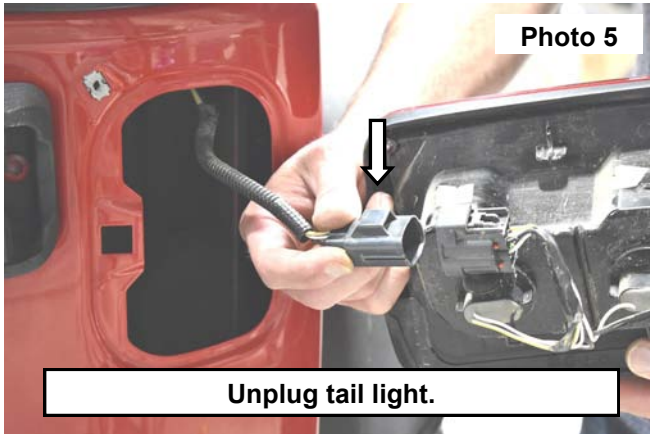

6. Remove the top trim panel, unclip the back trim panel then pull the speaker trim panel back to make access for the wiring. **See Photo 7.**
7. Remove the tape from the ends of the fabric wire covering on each end, pull the wire through the tailgate and push the gromet in the tailgate that was installed in photo 1 on previous page.
8. Insert the license plate light wire through the fabric covering and tape the ends using electrical tape. **See Photo 8.**

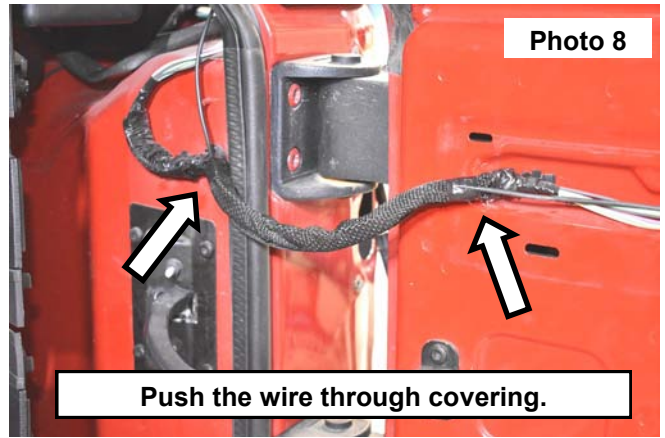
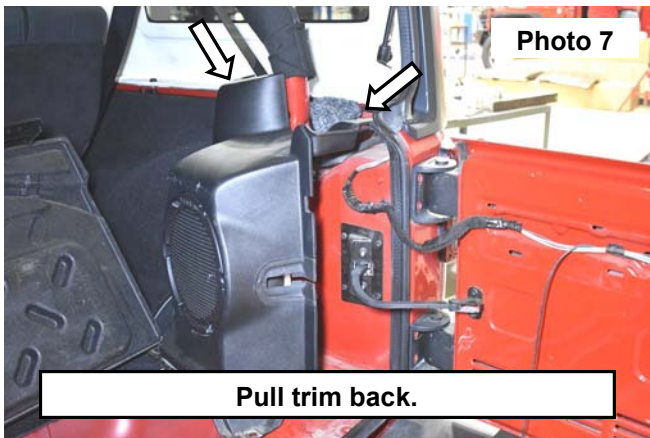

9. Insert the light wire into the rubber gromet in the upper right rear corner. **See Photo 9.**
10. **Note the top/clip side of the plug.** Make connections to the 1st and the 2nd wires from the left, connect the supplied black wire to the 1st wire on the plug, connect the red wire to the 2nd wire on the plug. **See Photo 10.**

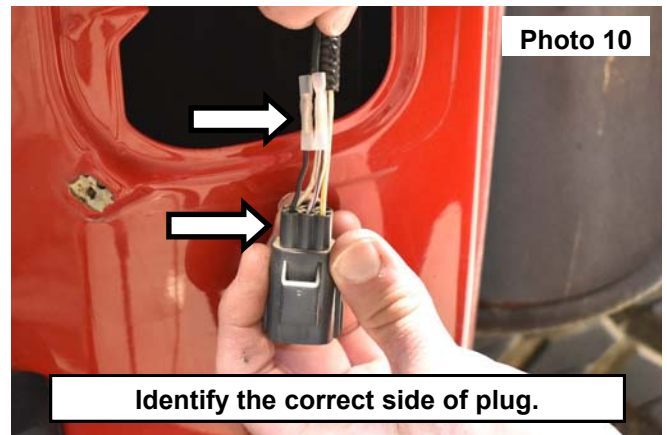
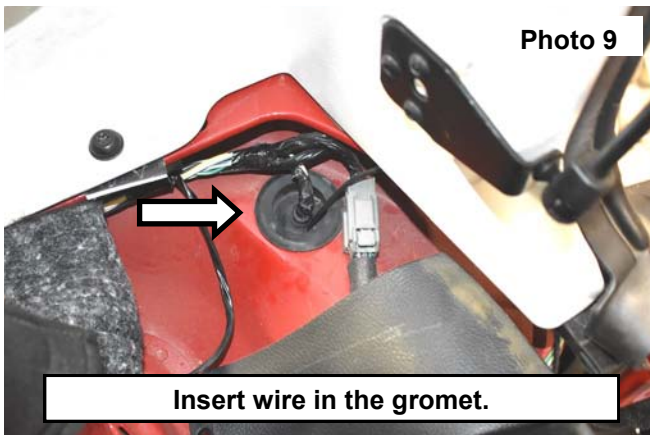



11. Secure the wires onto the tail light wiring harness, plug the stock tail light harness back into the tail light. Install the tail light using the retained hardware use a Philips screw driver. **See Photo 11. Do not over tighten.**
12. Secure the wires on the inside leading through the fabric wire covering, clip the speaker trim panel back together. And install the OE bolts and tighten using a T30 bit. **See Photo 12.**
13. Re install the 2 trim panels on the tale gate, use care installing with the factory clips.





By purchasing any item sold by Rough Country, LLC, the buyer expressly warrants that he/she is in compliance with all applicable , State, and Local laws and regulations regarding the purchase, ownership, and use of the item. It shall be the buyers responsibility to comply with all Federal, State and Local laws governing the sales of any items listed, illustrated or sold. The buyer expressly agrees to indemnify and hold harmless Rough Country, LLC for all claims resulting directly or indirectly from the purchase, ownership, or use of the items.

